



BenchMate[®]

HORIZONTAL I.D. RING HOLDER

INSTRUCTIONS • #004-877

1. CHANGING BENCHMATE ENCORE[®] QC FIXTURES

FIXTURE REMOVAL

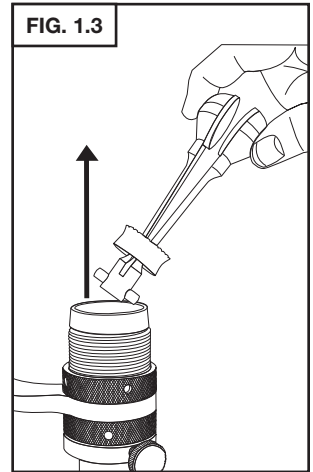
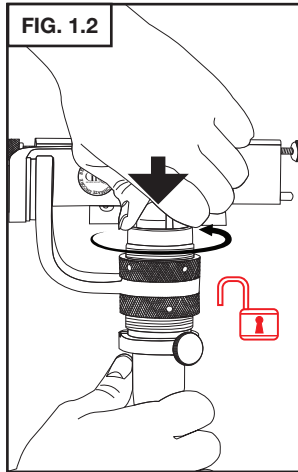
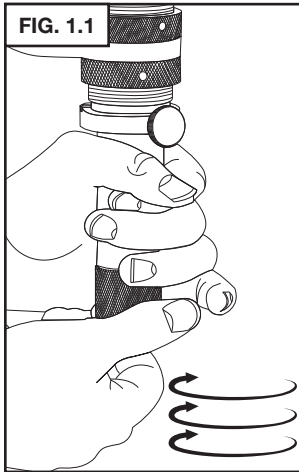

FIXTURE INSTALLATION

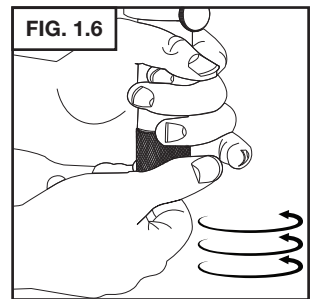
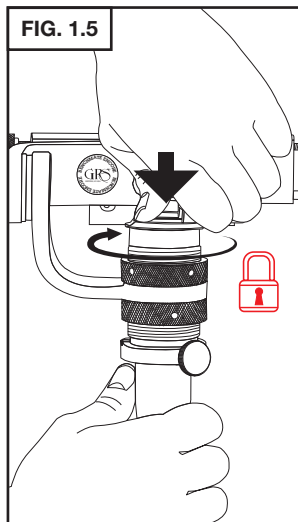
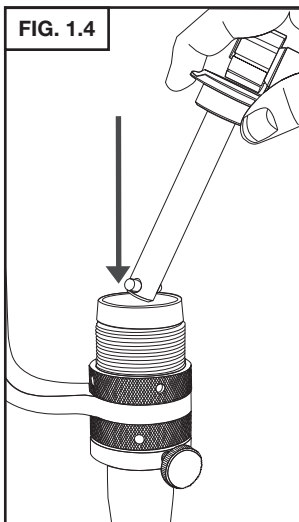

WARNING

Make sure QuickChange fixture is seated fully before tightening with mandrel knob. A fixture can be ejected with force if not properly seated when tightening.

2. WORKHOLDING

STANDARD DRAWBAR

FIG. 2.1

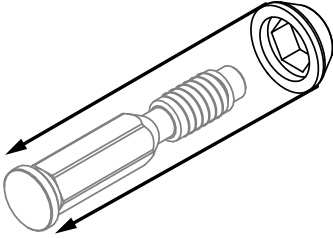

FIG. 2.2

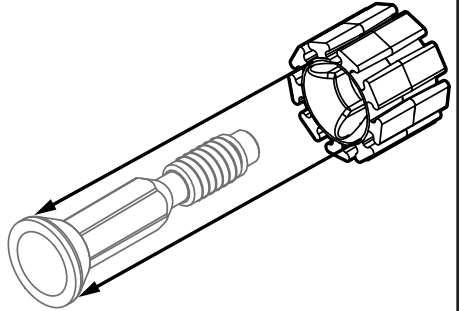

FIG. 2.3

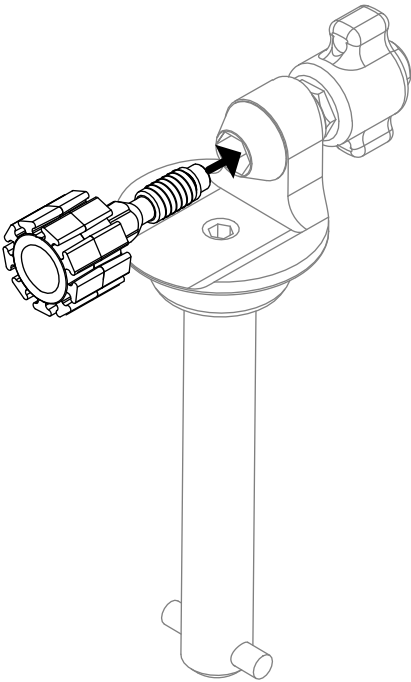

FIG. 2.4

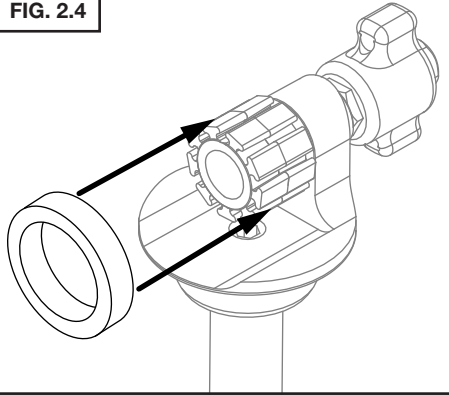
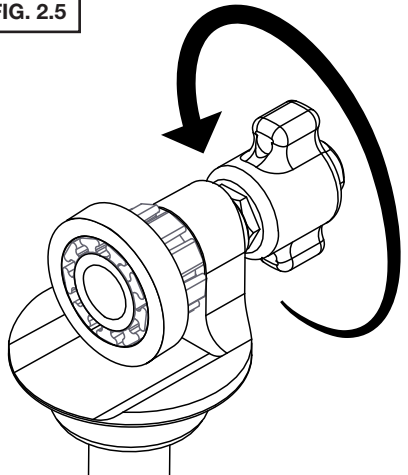

FIG. 2.5



LONG DRAWBAR

FIG. 2.6

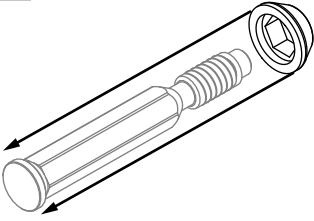

FIG. 2.7

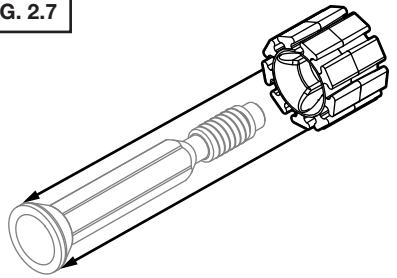

FIG. 2.8

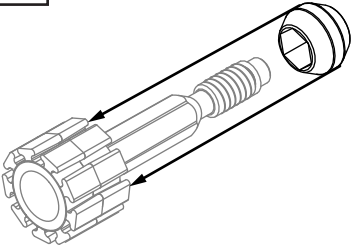

FIG. 2.9

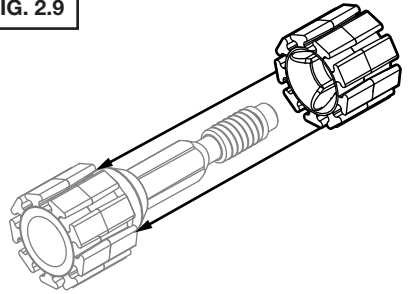

FIG. 2.10

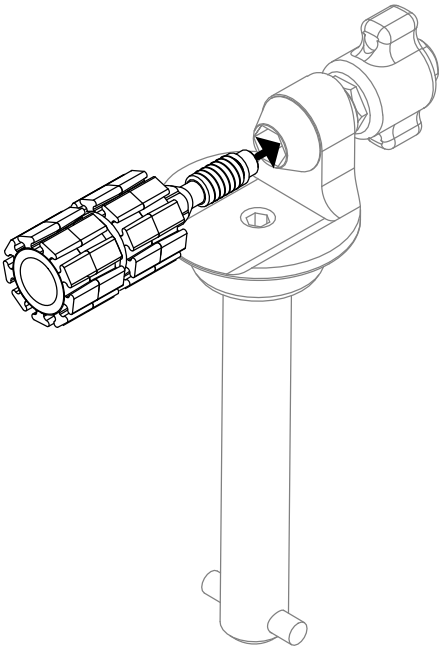

FIG. 2.11

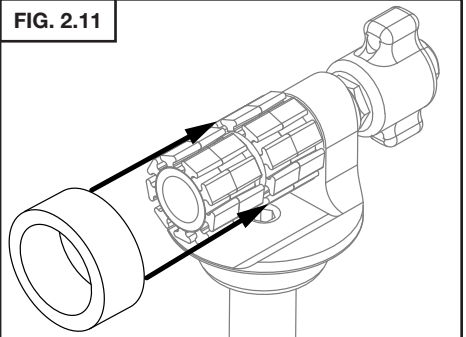
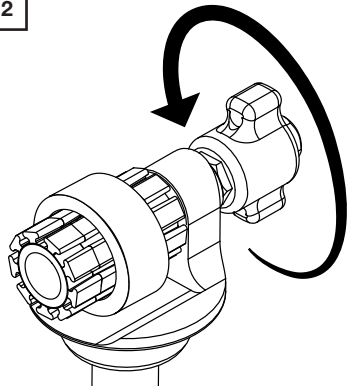
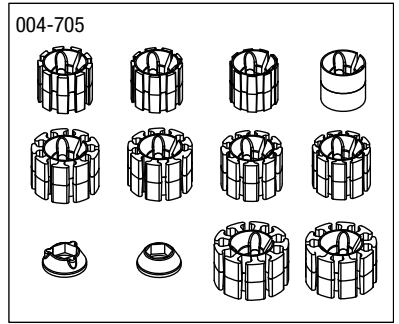
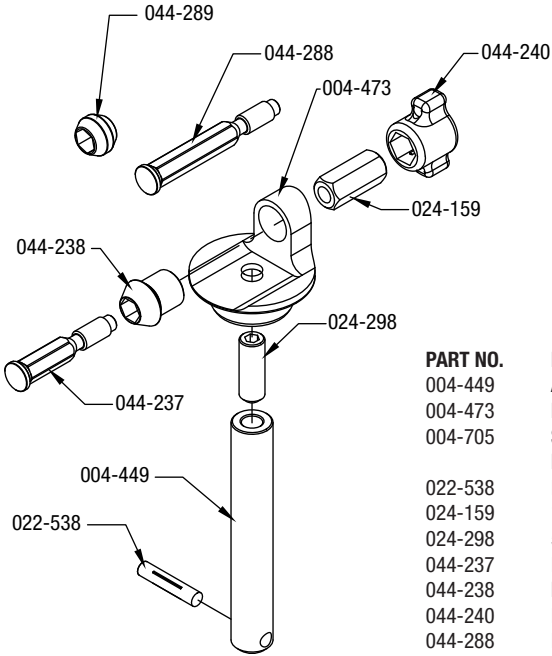

FIG. 2.12



PARTS LIST



PART NO.	DESCRIPTION	QTY
004-449	ACCESSORY MOUNT	1
004-473	INSIDE RING HOLDER HORZ STD HEIGHT	1
004-705	SET OF 10 MOLDED ID MANDRELS WITH 2 EXPANSION CONES BAGGED	1
022-538	DRIVE LOC PIN	1
024-159	1/4-28 X 7/8BLG Z/P COUPLER NUT 3/8 HEX	1
024-298	5/16-18 SOCKET HEAD SET SCREW X 7/8	1
044-237	DRAWBAR FOR NEW STYLE ID RING HOLDER	1
044-238	FRAME MOUNTED MANDREL EXPANSION CONE	1
044-240	DRAW BAR KNOB FOR ID RING HOLDER	1
044-288	DRAWBAR FOR STACKED MANDRELS	1
044-289	CENTER CONE FOR STACKED MANDRELS	1