

JURA

BY GRS®



QC COMPLETE SET INCLUDING MICROBLOCK® XL

500 - 527 • INSTRUCTIONS

Includes: MicroBlock XL® w/ Jura Master Jaws, Small Vise Base, Jura Must Have 5 mm Hex Key, Organizers, Horizontal Inside Ring Holder, Vertical Inside Ring Holder, 10 Plastic Collets, Flat Clamps with Groove, Outside Ring Holder, 6 mm Cylinder Top, 10 mm Cylinder Top, 20 mm Round Top, 20 mm Straight Top, 40 mm Straight Top, Engravers Clamps with 2.34 mm Holes, Thermo-Loc® Engravers Clamps, Shellac Plate, Thermo-Loc Cylinder, Shellac Cylinder, Tapered Point Holders, Tapered Ball Holders

MASTER JAWS

INSTRUCTIONS

Instructions apply to the following product(s):



500-018

IMPORTANT NOTE:
The MicroBlock® and MicroBlock® XL Jura by GRS sets include a pair of Master Jaws instead of the original jaws with pin holes.

Skip to **Installation of Master Jaws** unless you need to remove original MicroBlock jaws from a previously purchased vise.

Products that include Master Jaws instead of original MicroBlock jaws:
#500-508, #500-510, #500-517,
#500-526, #500-527

✓ Included with this set.

◆ Not included with this set. Available separately.

Removal of Original MicroBlock® Jaws

Skip to **Installation of Master Jaws** unless you need to remove original MicroBlock jaws from a previously purchased vise.



Installation of Master Jaws

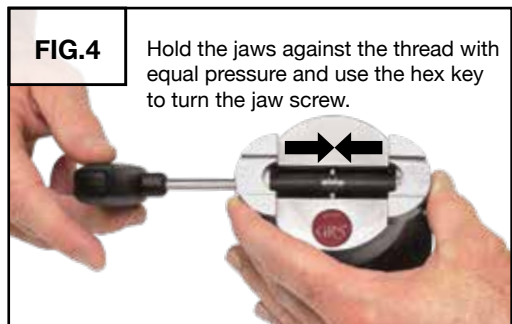

Microblock® XL shown with Jura Master Jaws
#500-018 (See instructions for installation on pg 2).

MICROBLOCK® XL W/ MASTER JAWS

INSTRUCTIONS AND PARTS LIST

FIG.1

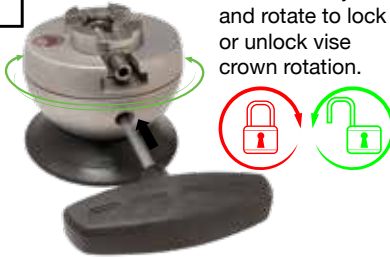

Insert hex key
and rotate to lock
or unlock vise
crown rotation.

FIG.2

Insert hex key into either end of
jaw screw and rotate to open jaws
and close jaws.

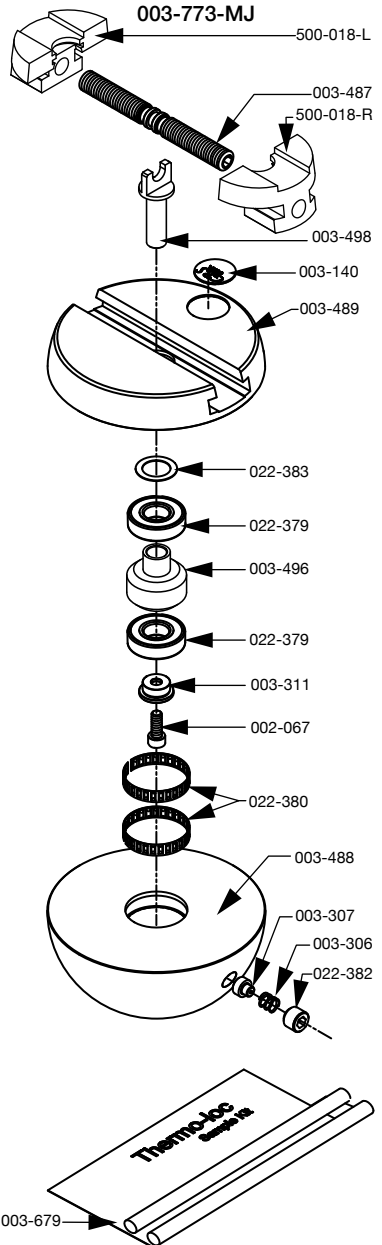
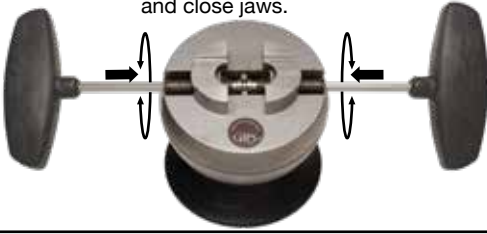

PART #	DESCRIPTION	QTY
002-067	SHCS, #10-32 X .50" BLK	1
003-140	LABEL, GRS	1
003-306	BRAKE AND DRAG SPRING	1
003-307	BRAKE ELEMENT FOR MICROBLOCK VISE	1
003-311	BEARING RETAINER FOR MICROBLOCK VISE	1
003-496	BEARING SPACER BRAKE ROTOR MICROBLOCK	1
003-498	YOKE TO SUPPORT AND CENTER JAW SCREW	1
003-487	JAW SCREW FOR MICROBLOCK XL VISE	1
003-488	416 STAINLESS STEEL MICROBLOCK XL BALL BASE FOR MEDIUM VISE	1
003-489	CROWN FOR MICROBLOCK XL VISE	1
003-679	THERMO-LOC SAMPLE KIT	1
022-379	R8 SHIELDED BEARING	2
022-380	TOLERANCE RING	2
022-382	FLAT NOSE SET SCREW	1
022-383	.015 X .513 X .750 SS SHIM WASHER	1

SEATED QC FIXTURES

INSTRUCTIONS

Instructions apply to the following product(s):

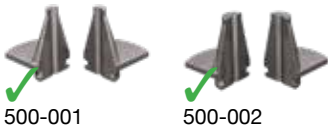

✓ Included with this set.
 ◆ Not included with this set. Available separately.

Fixture Attachment



BOTTOM



SIDE



ANGLE

Master Jaw Seat



Fixture Installation



INSIDE RING HOLDER SCREW SET

INSTRUCTIONS

Instructions apply to the following product(s):



500-011

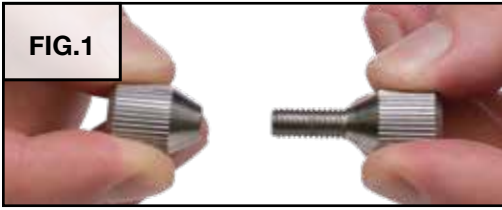

SHELLAC CYLINDER

INSTRUCTIONS

Instructions apply to the following product(s):



502-015



Follow the shellac instructions to apply shellac and workpiece to cylinder.

THERMO-LOC® CYLINDER

INSTRUCTIONS

Instructions apply to the following product(s):



502-502

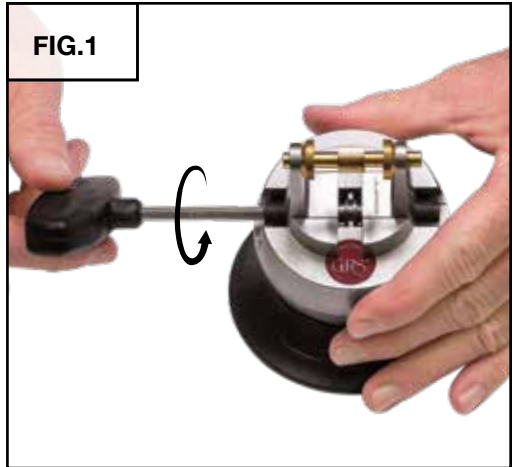

Follow the Thermo-Loc® instructions to apply Thermo-Loc® and workpiece to cylinder.

✓ Included with this set.

◆ Not included with this set. Available separately.

Fixture Installation

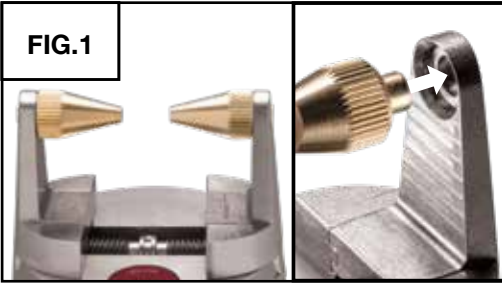

POINTED AND TAPERED BALL HOLDERS

INSTRUCTIONS

Instructions apply to the following products:



Fixture Usage

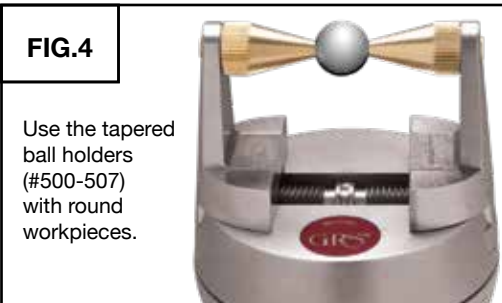
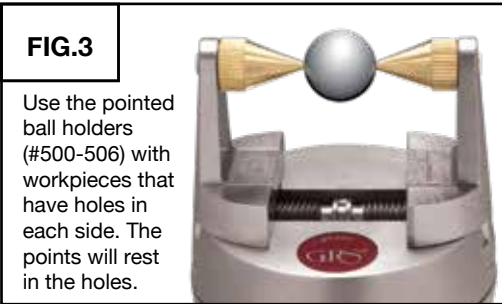
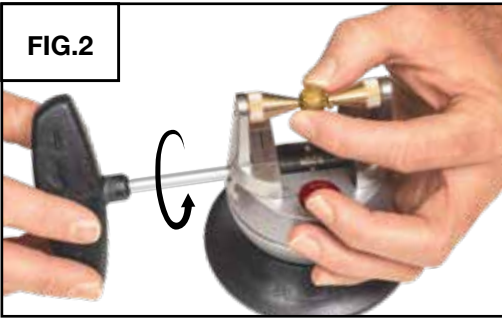

ROUND-BASE QC FIXTURES

INSTRUCTIONS

Instructions apply to the following product(s):

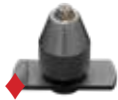

500-501



502-501

Fixture Attachment



BOTTOM



SIDE



ANGLE

Fixture Installation

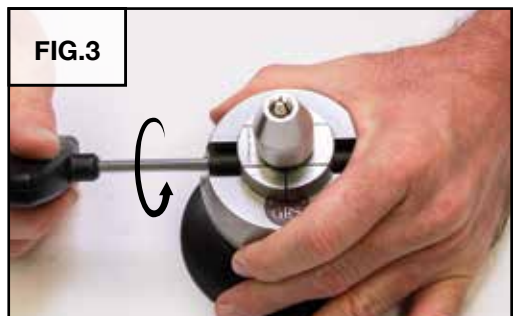
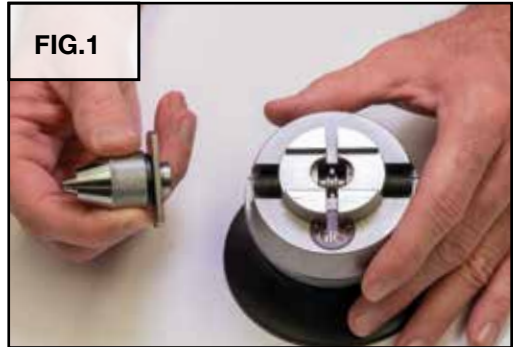

✓ Included with this set.

◆ Not included with this set. Available separately.

VERTICAL RING HOLDER

INSTRUCTIONS

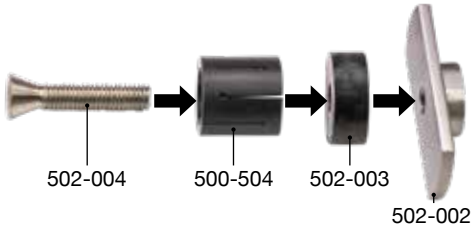

Instructions apply to the following product(s):

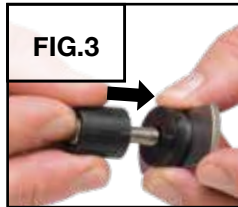
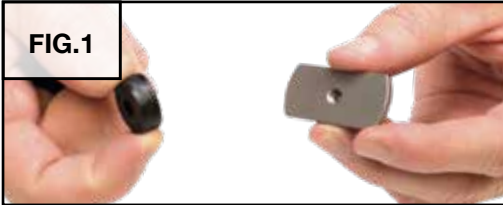

QC SHELLAC PLATE

INSTRUCTIONS

Instructions apply to the following product(s):



500-014

Fixture Attachment

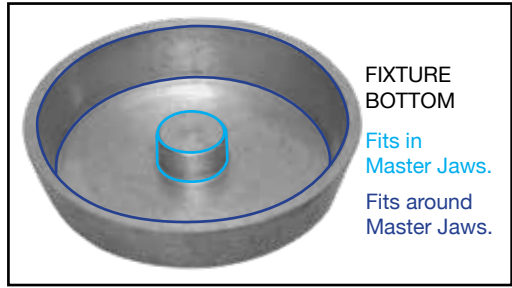

Fixture Installation



✓ Included with this set.

◆ Not included with this set. Available separately.

Follow the shellac instructions to apply shellac and workpiece to plate.



FIG. 1

Clean organizer back and bench surface with isopropyl alcohol according to manufacturer's instructions.



FIG. 2



FIG. 3



FIG. 4



FIG. 5



FIG. 6

Place organizer where desired and press firmly for 60 seconds.

ORGANIZERS WITH TAPE ATTACHMENT

INSTRUCTIONS

Instructions apply to the following product(s):



500-523



500-524



502-034



502-045



523-011



523-012



523-013



523-029



523-030

