

# GraverHone® VS

OPERATION AND MAINTENANCE MANUAL

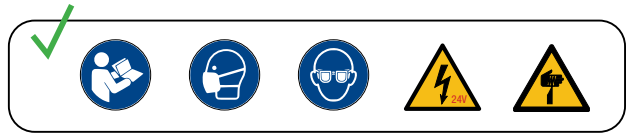

**Read this manual entirely before connecting to power source.**  
 Damage not covered by the warranty may result from not following the instructions and maintenance in this manual.

## IMPORTANT NOTICE FOR OPERATORS

**No user serviceable parts inside.** Do not remove any outer surfaces. Do not modify this equipment or remove warning labels. Modifications can increase risks to the operator. Do not use this equipment if it is damaged.

Always wear sufficient eye protection. Take steps to avoid dust inhalation by wearing appropriate respiratory protection.

Do not lift or transport by grasping the drive plate or spindle. Allow the drive plate and sharpening wheel to come to a complete stop before:

- grasping the drive plate and / or wheel
- changing the wheel
- grasping or attempting to remove the wheel lock

Plug into grounded outlets only. **Do not use adapters that bypass the ground plug.**

**Do not apply excessive or forceful pressure to a tool while using this unit.** This action may result in damage to the tool, the unit and its components, and / or the operator.

**Tools may become hot while operating this unit as intended.** Protect skin and surfaces from burns or damage.

**Tools can be extremely sharp after this unit is used as intended.** Protect skin and surfaces from punctures, cuts, or damage.

Do not attempt to operate this unit in any position other than upright as shown with the Front View in FIG. 1 on page 3.

The proper use of this equipment does not generate noise above 70dB(A).

## FOR URGENT SITUATIONS, STOP THE UNIT IMMEDIATELY BY:

- Powering off the unit with the power switch button
- Setting the reversing rocker switch to the center “off” position
- Disconnect the 24-volt power cord from the back of the unit
- Disconnect the 24-volt power cord from the electrical power source

## INTRODUCTION

The GraverHone® VS is designed to be used for the purpose of sharpening and polishing tools.

## REQUIRED EQUIPMENT

- **A sturdy surface with adequate lighting.**

Make use of a heavy workbench or suitable solid furniture to support this equipment, workpiece, and any additional equipment and supplies. Adequate lighting allows clear sight, and may help prevent accidents and reduce fatigue.

- ⚠️ **Respiratory protection appropriate for the material being ground.**

The dust created while sharpening some tool materials may present a health risk.

- **Eye protection.**

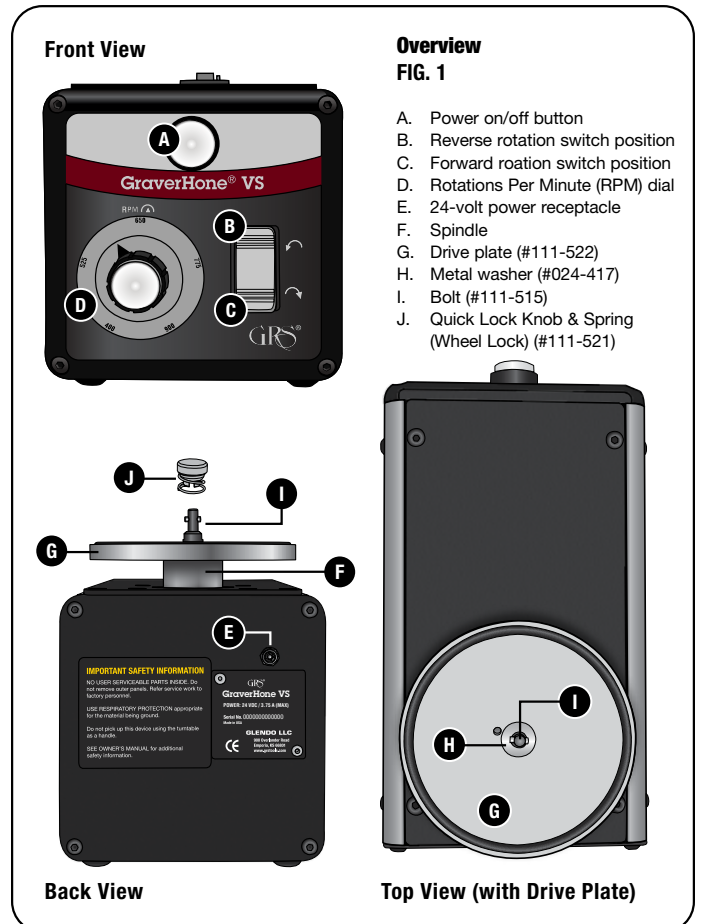

## SETUP

### ATTACH DRIVE PLATE & WHEEL (FIG. 2)

Place drive plate (G) on spindle (F). Place metal washer (H) in inset at center of drive plate. Thread bolt (I) into center of drive plate and secure on spindle. Tighten with 12 mm wrench. Place wheel on drive plate. Align and place quick lock knob and spring (J) assembly over bolt. Push down and twist into locking position.

### CONNECT ELECTRICAL POWER (FIG. 3)

Insert the converter cord into receptacle on unit (FIG. 3.1). Connect the electrical power cord into the 24-volt power converter (FIG. 3.2). Connect the 3-prong power cord into a properly grounded power outlet.

## OPERATION

Press power on/off button to power unit on. (FIG. 1 A). **Unit must not be in operation while installing or removing sharpening wheel.** If not installed, attach wheel securely on drive plate (FIG. 1 G). Position RPM dial to desired RPM setting (FIG. 1 D).

Set rotation switch to clockwise (FIG. 1 C) or counter-clockwise (FIG. 1 B) as desired. When finished, set rotation switch to center "off" position. When finished, press power on/off button to power unit off. (FIG. 1 A).

## MAINTENANCE

To maintain this unit, keep all surfaces free of dust and debris with regular cleaning using a damp cloth. Take appropriate measures to avoid inhaling dust while cleaning.

## SERVICE & REPAIR

Please call GRS or an authorized GRS dealer for service and repair. Unauthorized servicing will void the 2-year warranty. **This unit is not serviceable by the operator and must be sent in to GRS or an authorized GRS dealer for repair.**

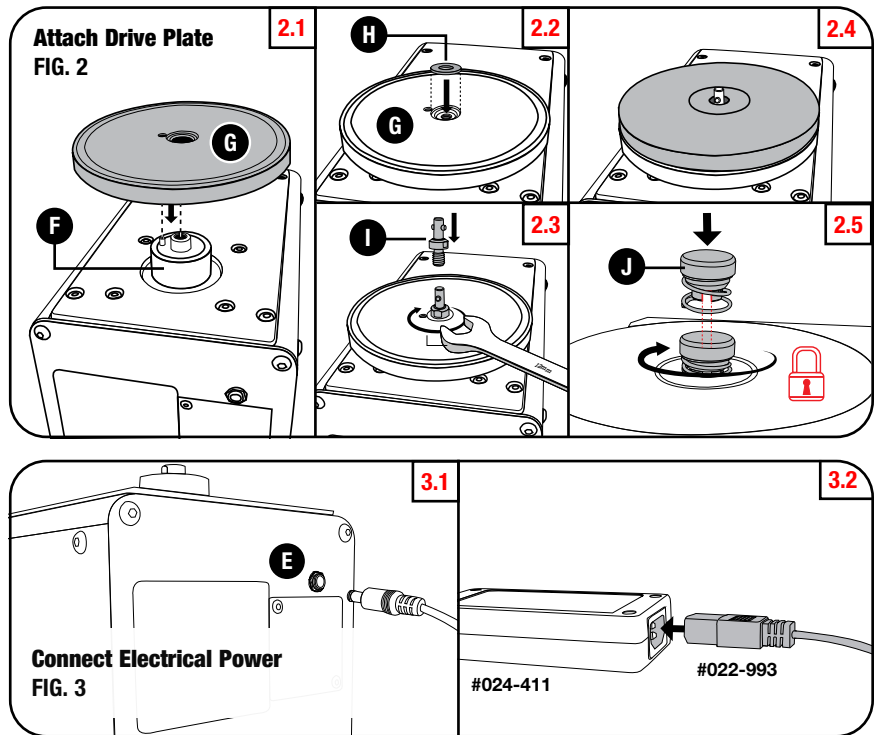

## READ THIS MANUAL ENTIRELY BEFORE CONNECTING TO POWER.

Damage not covered by the warranty may result from not following the instructions and maintenance in this manual.

## WARRANTY

Each GraverHone® VS carries a full 2-year warranty covering parts and labor. Contact GRS or an authorized GRS dealer before returning any equipment.

For guidance with operation or maintenance, please contact GRS or an authorized GRS dealer. To send a request for assistance via electronic formats, e-mail [support@glendo.com](mailto:support@glendo.com) or visit:

<https://www.grs.com/customer-service/>



Glendo LLC

900 Overlander Road  
Emporia, KS 66801 USA

Phone: +1-620-343-1084

Fax: +1-620-343-9640

E-mail: [glendo@glendo.com](mailto:glendo@glendo.com)

[grs.com](http://grs.com)

LIT-442

Last Update: 2023-02-01