

QUICK SET UP INSTRUCTIONS

GraverSmith®

1

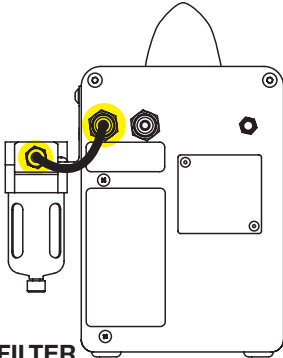

GRS® AIR FILTER

Connect the air filter to the GraverSmith® by loosening the side cover screw and sliding the bracket onto the screw. Re-tighten screw.

Find the black hose 139mm (5 1/2"). Connect one end to the **air input quick connect fitting** on the back of the machine and the other end to the straight **quick connect fitting**.

Connect the air compressor hose to the 90° **quick connect fitting** or the barbed fitting supplied.

NOTICE: This machine requires clean, dry, oil-free air. We suggest using an oil-free compressor. If your compressor is an oil type, you MUST have an oil removal filter, coalescing type (#004-730 or equivalent), in the air supply line to this machine. If you are unsure of this requirement, please call 800-835-3519 and ask for Technical Services. OIL CONTAMINATION IS NOT COVERED BY WARRANTY.

2

GRS® FOOT THROTTLE

Connect the foot throttle hose to the **throttle connection** on the back of the machine.

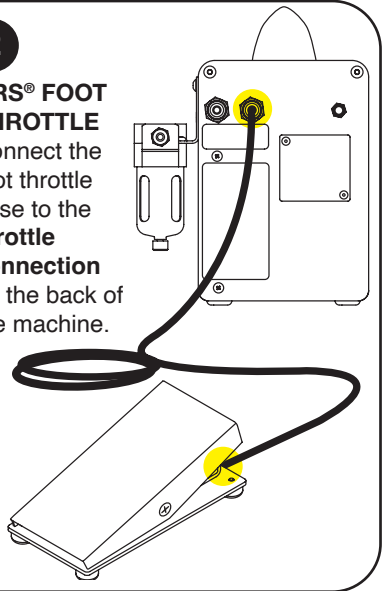

3

POWER SUPPLY

IMPORTANT:

The rotary valve is lubricated by air passing through it. Do not run electrical system unless air system is on.

Connect the electrical power cord into the 24 Volt converter box. Plug the converter cord into the jack on the back of the machine.

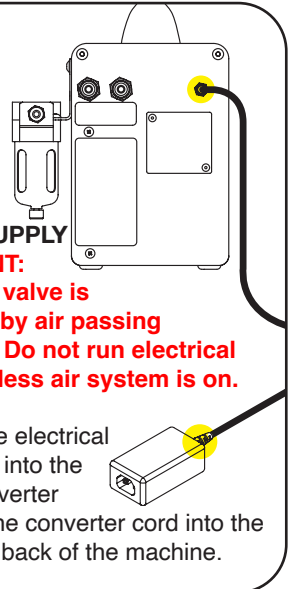

4

GRS® IMPACT HANDPIECE

Connect the
handpiece
hose to the
handpiece
quick
connect
fitting.

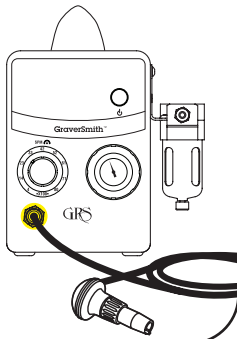

5

HANDPIECE TUNING

Set the **stroke per
minute (A)** to 2300.
Set the main **air
regulator knob (B)**
to 0.1 ~ 0.4 BAR
(2~5 PSI).

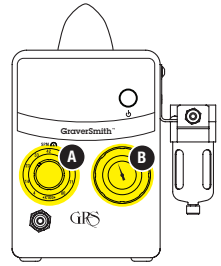

Hold the handpiece
you have selected
to use vertically, tool
holder end up, next
to your ear. Without
depressing the foot
throttle or palm
control, **SLOWLY**
increase the air
pressure until the handpiece begins
to buzz. Continue to increase the air
pressure until the handpiece vibrates
and knocks. Slowly add air pressure
until the knocking stops and add 2
psi (.13 bar). This is the perfect air
pressure for each handpiece. Now you
are free to move the SPM (strokes per
minute) dial to whatever setting desired.

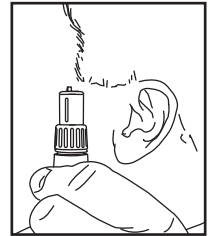

GLENDO LLC

900 Overlander Road • P.O. Box 1153
Emporia, KS 66801 USA
800-835-3519 • 620-343-1084 • Fax: 620-343-9640
glendo@glendo.com • grs.com
Last Updated: 2022/07/18

LIT-328