

# GRS Regulator Replacement Instructions

For GRS GraverMax SC

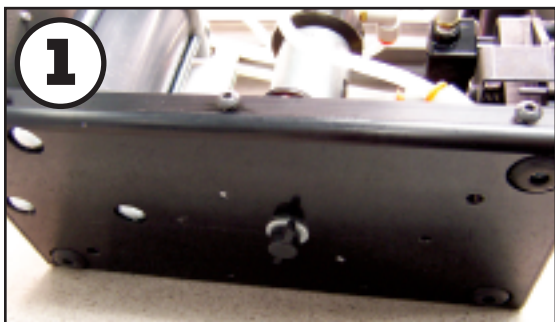

Before beginning this replacement, disconnect the air and electrical supply lines and install the motor mount locking screw.

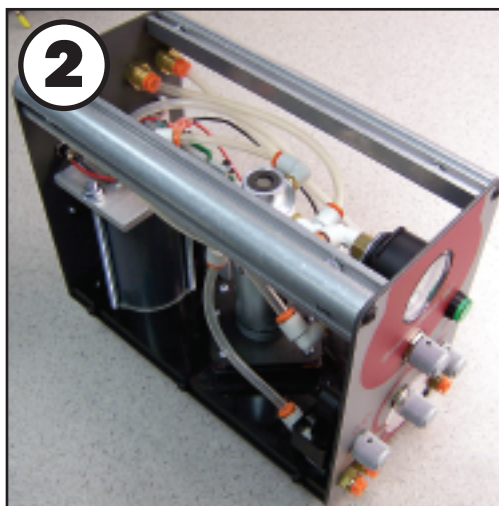

Remove the 2 side covers and the top cover using the 1/8" wrench supplied with kit



Remove the regulator knob with the 1/16" wrench supplied with kit



Use a wrench to remove the regulator mounting nut

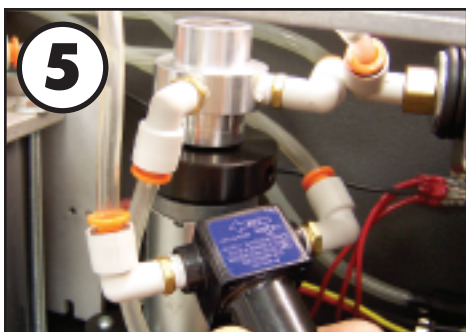

Gently remove the regulator from the mounting hole. Note the hose locations on the regulator and press the orange ring in to remove the hoses from the fittings

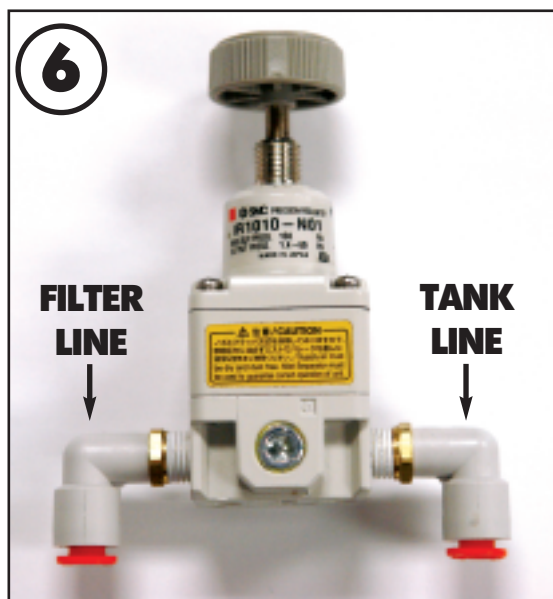

Note the arrow on the regulator. It shows the correct air flow direction. The incoming line from the filter goes on the "IN" side and the line from the regulator to the tank goes on the "OUTPUT" side as seen on the back of the regulator housing.

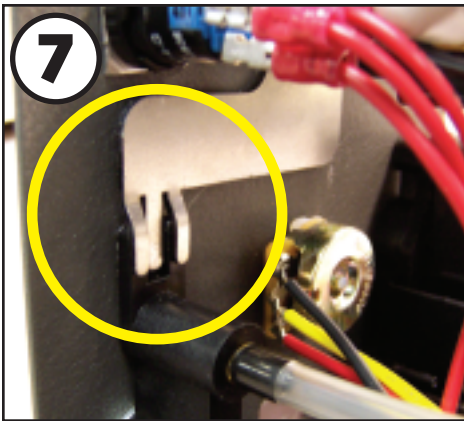

When re-installing the regulator make sure the regulator mount fingers locate on the back of the output valve as seen in picture. Carefully screw the regulator mounting nut until it is snug against the front face of the machine. **DO NOT OVER-TIGHTEN THIS NUT!** Install the regulator knob on the shaft and push it all the way down. Tighten the set screw with the 1/16" wrench.

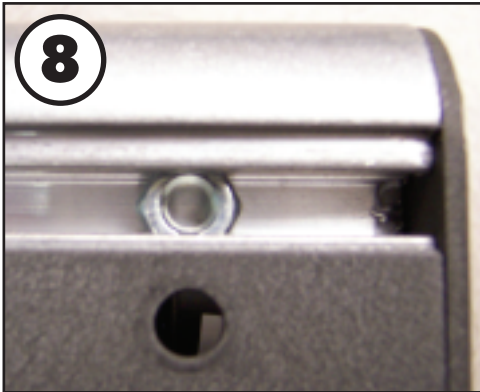

Replace the 2 side covers and the top cover by first aligning the rail nuts by laying the cover under the nut locations

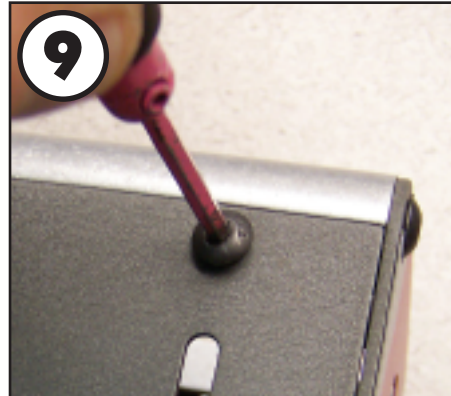

Gently tighten the cover screws until snug. **DO NOT OVER-TIGHTEN**

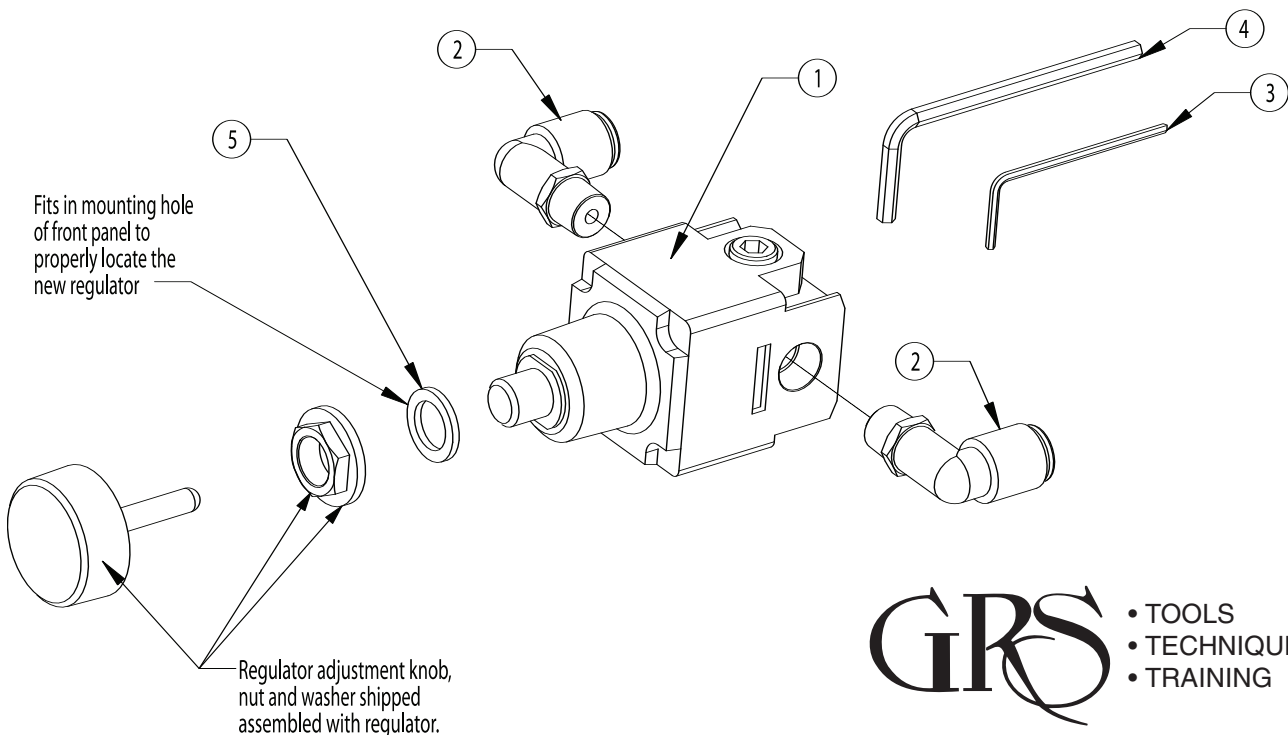

**GRS** • TOOLS  
• TECHNIQUES  
• TRAINING

## GRAVERMAX SC REGULATOR KIT # 004-825

- |   |         |                                              |
|---|---------|----------------------------------------------|
| 1 | 022-980 | IR1000-NO1 SMC Regulator                     |
| 2 | 022-230 | 90 Degree Elbow                              |
| 3 | 002-727 | 1/16" Hex Wrench                             |
| 4 | 022-053 | Allen Wrench, 1/8" Hex Key                   |
| 5 | 022-824 | Washer .587" x .400" x .060" Stainless Steel |

**Glendo Corporation**  
900 Overlander Road  
Emporia, KS 66801 USA

Phone: 1-800-835-3519  
Fax: 620-343-9640  
Tel: 620-343-1084  
e-mail: [glendo@glendo.com](mailto:glendo@glendo.com)  
website: [www.GrsTools.com](http://www.GrsTools.com)